

RESOLUTION NO. 3-2018

HARRISBURG REDEVELOPMENT AUTHORITY

AND NOW, BE IT RESOLVED by the Redevelopment Authority of the City of Harrisburg as follows:

1. That the Redevelopment Authority of the City of Harrisburg is authorized, if acquisition cannot be completed amicably, to exercise its power of Eminent Domain and appropriate title in fee simple absolute to one parcel of real estate, in whole or in part, together with the access alleys, located within the City of Harrisburg. Such parcel is listed on Exhibit "A", which is attached hereto and made a part hereof, together with all of the Condemnees right, title and interest in and to any and all streets, alleyways, easements and rights-of-way and appurtenances to said premises.
2. That the condemnation thereof be effected by the Redevelopment Authority of the City of Harrisburg by filing a Declaration of Taking in the Court of Common Pleas of Dauphin County, Pennsylvania, or recording of a Deed in Lieu of Condemnation in the Court House in and for Dauphin County, Pennsylvania.
3. That the Executive Director and the officers, agents and employees of the Redevelopment Authority of the City of Harrisburg are authorized to make, do and perform each and every action on behalf of said Redevelopment Authority as may be necessary or appropriate in completing the acquisition of the parcels, including condemnation proceedings, if required.

ADOPTED this 24th day of April, 2018

4-24-18

Date

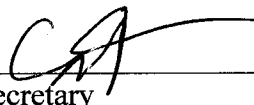

Secretary

Exhibit A

1828 Walnut Street

15-017-021

PREMISES: 1828 Walnut Street
City of Harrisburg
Dauphin County, Pennsylvania
Tax Parcel No. 15-017-021

LEGAL DESCRIPTION

ALL THAT CERTAIN lots or pieces of ground with improvements thereon erected, situate principally in the 15th Ward, and partly in the 8th Ward of Harrisburg City, Dauphin County, Pennsylvania, being described and numbered as Lots No. 255, 256, 257 and 258 on a Plan of Lots laid out by C. Long's Estate and recorded in the Dauphin County Recorder of Deeds Office in Plan Book B, Page 47, and being known and numbered as No. 1828 Walnut Street, further bounded and described as follows:



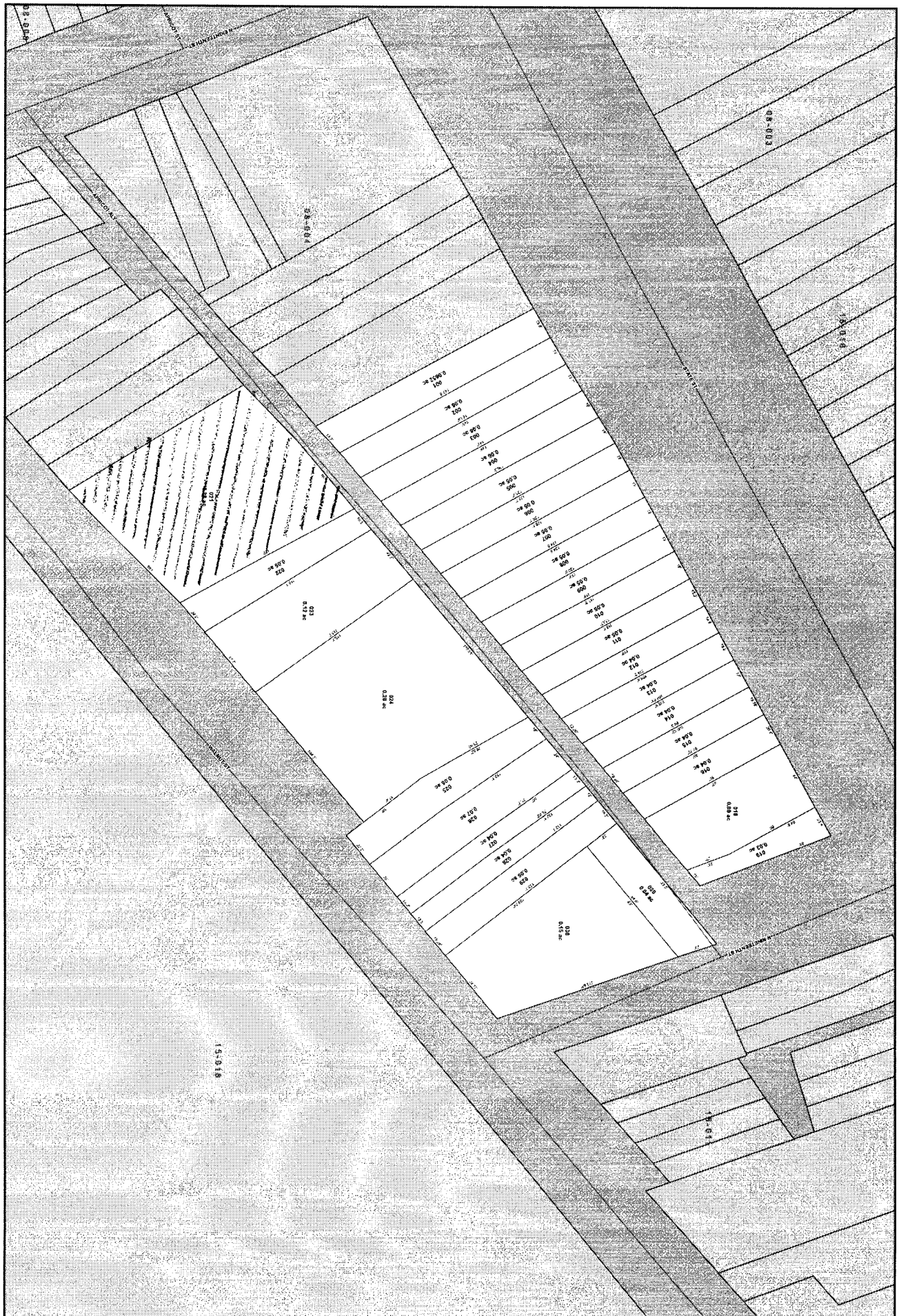

BEGINNING at a point on the north side of Walnut Street, about 206.00 feet east from the northeast corner of 18th and Walnut Streets, at the property now or late of Harrisburg School District; thence eastwardly along Walnut Street, 103.00 feet more or less, to property now or late of Caroline R. Haldeman; thence northwardly along same, 119.00 feet to Reservoir Alley (as shown on Plan as "unnamed avenue") (15 feet wide, erroneously shown on Plan as 20 feet wide); thence westwardly along same, 103.00 feet, more or less, to property now or late of Harrisburg School District extended; thence southwardly along said extended property line and along property now or late of Harrisburg School District, 119.00 feet to the place of **BEGINNING**.

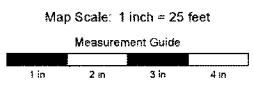

 Dauphin County
 Tax Assessment
 15-017
 Dist-Map
 Reference: Use Only

Geographic City of:
Harrisburg
 Dauphin County, PA



-  Surrounding Tax Maps
-  Parcels
-  Municipal Boundary
-  Water